

## CONTCF01

### Description

EXUFACE windows are delivered with the position switch already mounted and wired into the window frame. The switch is mounted in rabbit, making it invisible when the window is in the closed position. The connection box is also wired-up, so that the switch can be connected to the building's Fire Safety System.

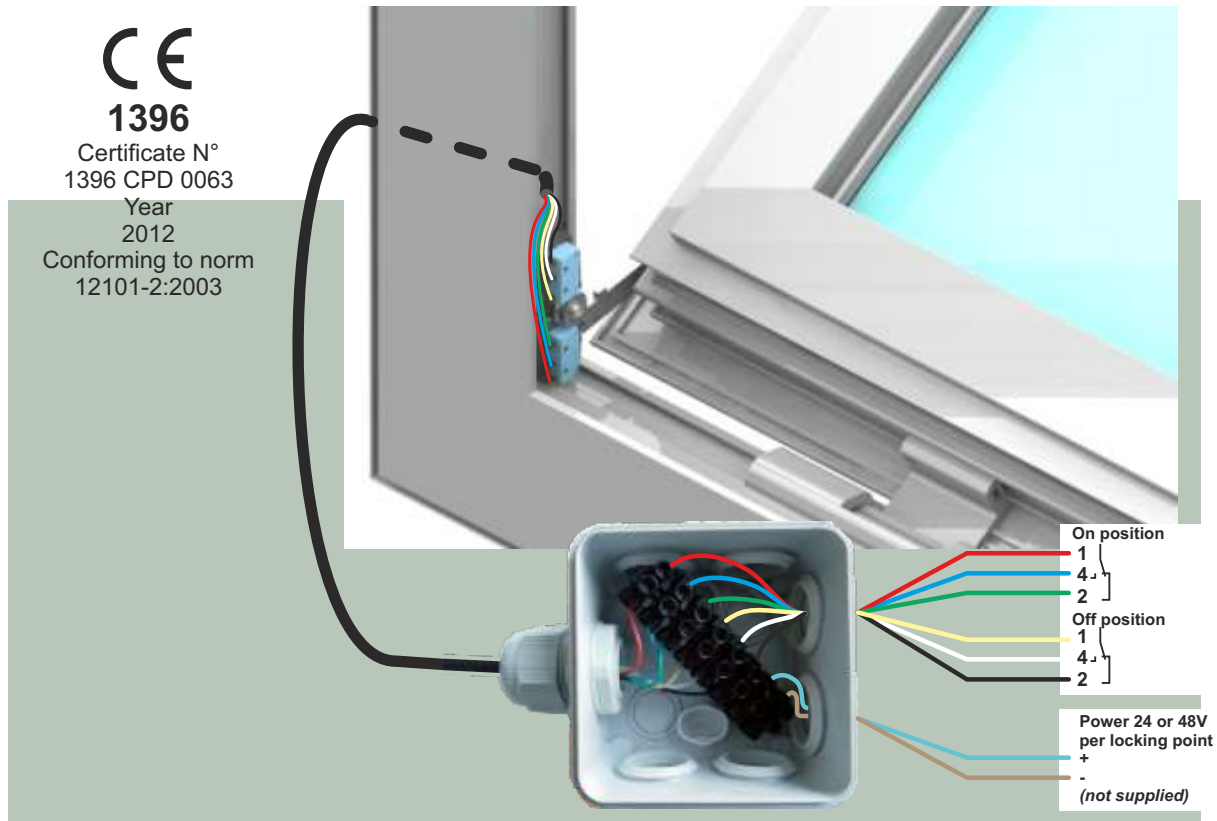

### Specifications

Connexion box	: IP55, dim. 75 x 75 x 45
Cable fastener Type	: Slatted cable clamp : PG13.5, for cable Ø 6 to 12mm
Position switch Type	: Change over : V4 83 170.0
Electric cable Type	: Shielded flexible cable, about 1m : 6C SCN 7x0.2

Interior view of the cover  
with wiring diagram

